

MEDTECH[®] 
Caring for life

MASSAGE GUN

GMV4

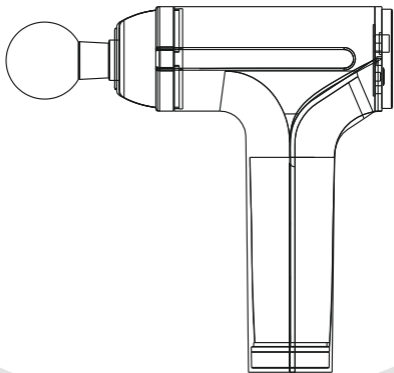

USER MANUAL

Thank you for buying our massage gun. Please read the user manual before use to ensure correct operation method.

Safety Precautions

! Statement

Please consult a doctor before use if you are in any of the following situations.

1. Pregnant women or shortly after delivery;
2. Heart disease or implanted pacemaker;
3. Fractures, osteoporosis, spine or joints are different;
4. Suffering from a malignant tumor.

⊘ Attention

1. It is forbidden for minors or someone who has gotten injured to use this product.
2. It is forbidden to use it on non-dry or non-clean skin surface. We would like to suggest you to using it across your clothes. Gently press and move on the skin, about 60 seconds for each part.
3. It is forbidden to use it on the parts that are above your neck, with less muscle coverage or your bones. Please use it only on the soft tissues of your body without pain or discomfort.
4. It is forbidden to use it when you get bruised or feel painful and uncomfortable.
5. It is forbidden to place any objects in the ventilation holes of it.
6. It is forbidden to immerse it in water. Meanwhile water is not allowed to enter the ventilation holes.
7. It is forbidden to put it into fire or near fire source.
8. It is forbidden to drop it intentionally.
9. It is forbidden to disassemble it in any way.
10. It is forbidden to put your fingers, hair or other parts near the axis or back of the massage head to avoid being pinched.



Warning

1. Please pull out the charger after charging.
2. Please use the massage head that can achieve the best massage effect.
3. Please do not use it over 15 minutes. If you want to continue to use, please let it stop 30 minutes and you can reuse it then .
4. Please use 5V $\overline{=}$ 2A or more charger to charge it.
5. Please remove the battery from the product before discarding it.
6. Please power off it before removing the battery.
7. The battery should be safely disposed.

Product Description

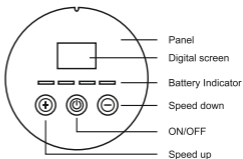
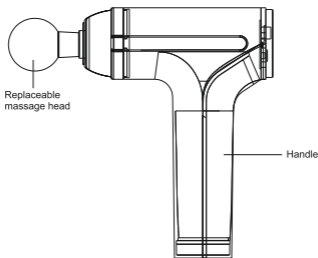

Equipped with six replaceable massage heads



Round massage head
For large muscle groups



Bullet massage head
For deep tissues



Flat massage head
For relaxing and
shaping various
muscle parts



Fork massage head
For both sides of neck
and spine and
Achilles tendon



Y Shaped head
suitable for arm
and leg muscles



Spade head for relaxation
& shaping of various
tissue parts.

Installation method of massage heads

Please turn off massage gun and slowly insert the massage head into the groove of the nozzle of it. When they are combined, the installation is finished.

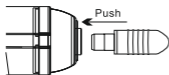

Correct installation direction

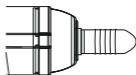

Finished

Operation Instructions

Charging method

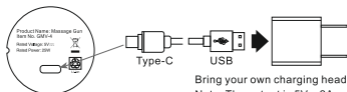

Bring your own charging head
Note: The output is 5V=2A or
more mobile phone charging head

1. Please fully charge the massage gun for about four hours before first use.
2. When charging, the blinking LED light indicates battery is charging.
3. When charging indicators stop blinking and are continuously on, massage gun is fully charged.

- ※ The massage gun can be charged at any time and at any battery level.
- ※ The massage gun cannot work during charging. It needs to be disconnected from the power supply before use.
- ※ Please keep the battery fully charged every three months if not use for a long time.

Using method

1. Touch the power button for 2 secs to turn on the massage gun at the first speed by default (the first speed indicator on). Each time you press the button, the speed will be increased until it reaches the sixth speed (six speed indicators on).
2. Long press the power button for 2 seconds to shut off the massage gun no matter at any speed.
3. The massage gun will be automatically off after 15 minutes. Turn on it when you need to use it again.

Cleaning & Maintenance

Please do remember to turn off the massage gun before cleaning.

- ▶ Please clean it with a slightly damp towel, then dry it with a soft cloth.
- ▶ Please do not use cleaners, cleaning brushes, gasoline, kerosene, glass cleaners or thinners to clean it.
- ▶ Please store it in the original box or put it in a safe, dry, cool and ventilated place after wiping off the dust and dirt.
- ▶ The massage gun is specially designed and manufactured, so there is no need to maintain or add lubricating oil regularly.

About battery recycling

 Warning	<ul style="list-style-type: none">● In order to protect the environment, please take out the battery after the end of life and recycle it in a unified manner. Please do not discard it at will.● Before the end of life, please do not disassemble the massage gun at will.
---	---

About battery removal

1. The battery can only be taken out from the massage gun after it is used up or the massage gun cannot work at all.
2. Please take the massage gun to the relevant after-sale service center to take out the battery.
3. Please prevent the short circuit of the positive and negative terminals of battery after taken out.

Troubleshooting

Please refer to the following tips and solutions if you encounter problems during use.

Problem	Possible solution
Cannot work	<ul style="list-style-type: none">● The massage gun maybe about to be dead. Please use it after fully charged.
Suddenly stop working	<ul style="list-style-type: none">● The massage gun maybe about to be dead. Please use it after fully charged.● Time is up. It will be auto. off after 15 mins.
A slight noise when working	<ul style="list-style-type: none">● This is due to the sound generated by the mechanical structure, not a malfunction. Please be noted.

Part list

1N GMV4, 6N Massage heads, 1N USB, 1N Zip Bag, 1N IFU.

Specification

Product Name: Massage Gun

Model: GMV4

Rated Voltage: 5V \equiv

Rated Power: 25W

Warranty conditions

Massage Gun GMV4 is made under strict quality control & utmost care is taken to ensure long, trouble free service.

- This unit is warranted for a period of 12 month from the date of purchase.
- We undertake to repair or replace at our discretion any part which was originally defective, provided the unit was not tampered with or mishandled.
- The warranty is only against manufacturing defects & shall not be applicable in case of damage due to accident, acts of nature, loss of components, intentional damage, and improper installation or if it was opened or service by authorized persons.
- The warranty is void, if the set is not operated according to instructions given in the "Instruction manual booklet", if any repair work is carried out by persons other than authorized company personnel, defects are caused by improper or reckless use, which shall be determined by company personnel.
- Warranty does not cover accessories external to the equipment, defects caused due to causes beyond control like lightning, abnormal voltage, acts of God or while in transit to service centre or to to purchasers/premises.

MEDTECH® 
Caring for life

**MESSAGE GUN
GMV4
WARRANTY CARD**

Subject to Mumbai Jurisdiction only

No.

Model

Serial No.

Invoice No. Date:

Stamp and Signature
of Dealer

Name and Address
of Dealer



Mfg. By

MEDTECH LIFE PRIVATE LIMITED

Regd. address : B6,Byculla Service
Industries, D.K.Marg, Sussex Road,
Byculla (East), Mumbai 400027,
Maharashtra, INDIA.

Customer Care No.+917208088720

E-Mail:support@medtechlife.com

Website : www.medtechlife.com



Plot No. 05, Morai
Industrial Park,
S.No. 315/5, Morai,
Valsad, Gujarat-396185